



KERK ST

3895

W DER
MERWE ST

142

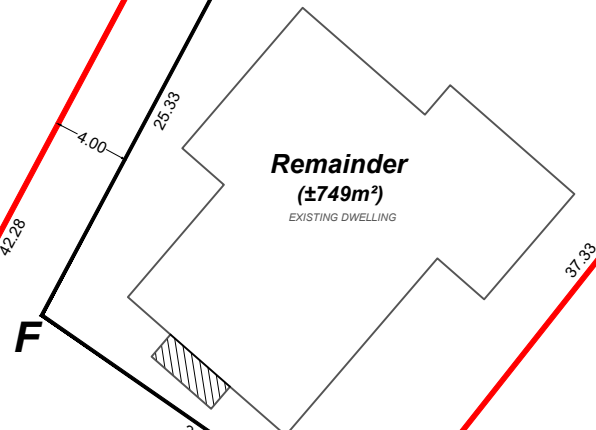
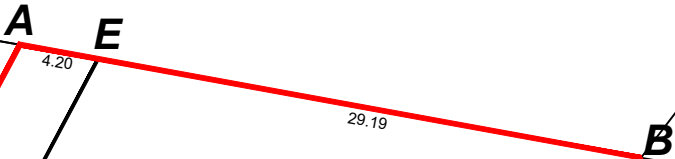

Remainder
(±749m²)
EXISTING DWELLING

Portion 1
(±536m²)

3449

D

G

14216

21.80

18.63

C

8242

3450

BARLINKA
ST

REVISION HISTORY:

- Rev A: Proposed subdivision of Erf 143, Wellington.
- Rev B: Structure to be demolished.

NOTES:

- All distanced and areas are to be verified by cadastral survey.
- Figure ABCD represents Erf 143, Wellington
- Figure EFG represents proposed subdivision line

- Structure to be demolished.

TITLE:

PROPOSED SUBDIVISION PLAN

SCALE: 1 : 400 (A4)

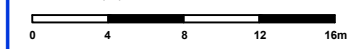

PROPERTY DESCRIPTION:

ERF 143, WELLINGTON

PROJECT DETAILS:

Project Name: Church St, Wellington
 Project No: 23006
 Client: Edu Hanekom
 Municipality: Drakenstein Municipality
 Administration: Wellington

PLAN DETAILS:

Plan No: 23006-001
 Revision: B
 Date: 2023-08-08
 Drawn by: RC
 Checked by: AR



Office: +27 (0)21 182 3171 | Cell: +27 8003 448 0078
 Email: andrew@arouxplanning.co.za
 Office B1: La Concorde Building, 57 Main Road, Pearl 7666

www.arouxplanning.co.za

The copyright in this drawing, including the design and the details shown herein, is reserved by Aroux Town Planning.