

ANNEXURE B

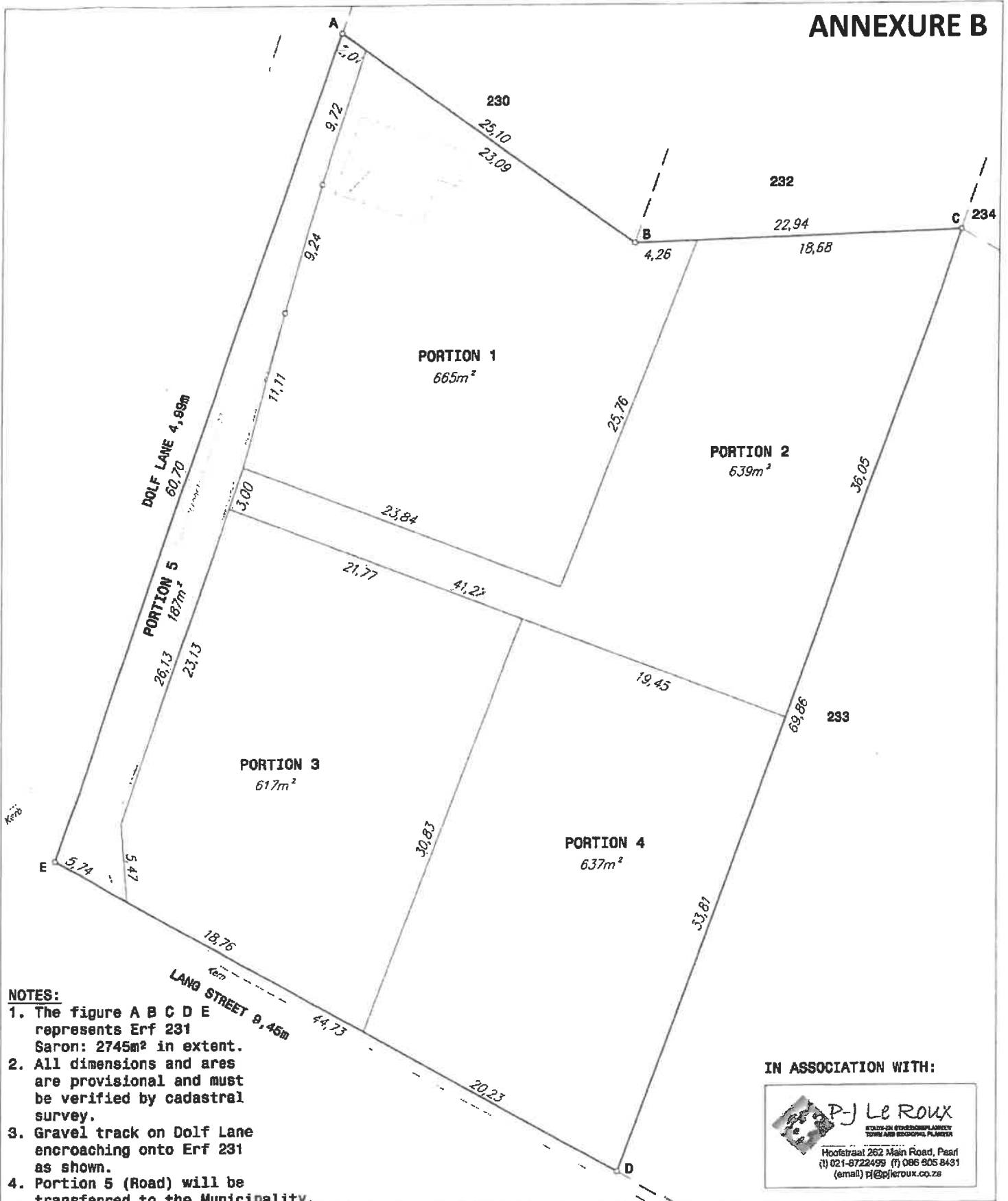

NOTES:

1. The figure A B C D E represents Erf 231 Saron: 2745m² in extent.
2. All dimensions and areas are provisional and must be verified by cadastral survey.
3. Gravel track on Dolf Lane encroaching onto Erf 231 as shown.
4. Portion 5 (Road) will be transferred to the Municipality.

IN ASSOCIATION WITH:

P-J Le Roux
KLASSIEK EN MODERNES LANDMET
 TOPIE EN BOERINGSPLANNEER
 Hoofstraat 252 Main Road, Paarl
 (t) 021-8722499 (f) 086 905 8431
 (email) p@pjleroux.co.za

DIÉ KOPIEREG IN HIERDIE TEKENING, INSLUITEND DIE ONTWERP EN BESONDERHEDE SOOS AANGEDUI WORD DEUR ALBERT GEIGER VOORBEHOU

THE COPYRIGHT IN THIS DRAWING, INCLUDING THE DESIGN AND DETAILS SHOWN HEREON, IS RESERVED BY ALBERT GEIGER

Albert Geiger
Professional Land Surveyor

2 NAPIER STREET/NAPIERSTRAAT 2
 SUITE 221 POSTNET X3036
 PAARL 7848
 ☎ (021) 8721427 ☎ 086 6848041
 e-mail : albert@geigergeo.co.za

REVISIONS WYSIGINGS	DATE/DATUM	DESCRIPTION/BESKRYWING
		11 MARCH 2022
	20 APRIL 2022	CHANGE PROPOSED SUBDIVISION LINE OF PORTIONS 1 AND 5
NORTH NOORD	SUBJECT ONDERWERP	DATE DATUM
	PROPOSED SUBDIVISION OF ERF 231 SARON	20-04-2022
DRAWN GETEKEN	AREA GEBIED	SCALE SKAAL
EB	SARON	1/250
FILE NO LÊER NR	DESCRIPTION BESKRYWING	DRAWING NO TEKENING NR
MISC332	231	MISC332/04/06